

GENERAL PUMP & EQUIPMENT CO., INC.

MANUFACTURING QUALITY HYDROSTATIC TESTING EQUIPMENT FOR CONTRACTORS AND INDUSTRY SINCE 1969
3276 BRUENING AVENUE SW
CANTON, OHIO 44706
PHONE 330-455-2100
TOLL FREE 800-594-5178
EMAIL gentest@bright.net

MODEL 6334-750 & 6334-1000 HYDRO-TEST PARTS LIST

<u>PART NO.</u>	<u>DESCRIPTION</u>
B11	Exterior Case
B12-750	TEFC Motor, 1 HP (6334-750) Pre-wired
B12-1000	TEFC Motor, 1.5 HP (6334-1000) Pre-wired
HT2-1000	B14-1000 Replacement Pump
HT2-1000R	B15-1000 Rebuilt Pump (Old Pump Exchange)
B16	Base Plate w/Rubber Feet
B17	Rubber Vibration Isolators
B18	Handle Grip
B19	Toggle Switch (6334-750)
B19-SG	Toggle Switch (6334-750) w/Switch Guard
B19-1000	Toggle Switch (6334-1000)
B19-1000-SG	Toggle Switch (6334-1000) w/Switch Guard
B20-750	Power Supply Cord
B20-1000	Power Supply Cord
B21	Rubber Feet
B22	Decal Pack
B20KT-750	Switch Kit (Includes switch, switch plate, cord w/connectors, cord grip and switch guard)
B20KT-1000	Switch Kit (Includes switch, switch plate, cord w/connectors, cord grip and switch guard)
B23	Rubber Grommets
B24	Bumper Block (Use under pump torque arm)
B25	Switch Guard
B26	Cord Grip

PUMP HEAD

P101-1000	Seal Kit
P120-1000KT	Seal Guide and O-Ring Kit (All seals and O-rings in Pump)
P130-1000KT	Check Valve Kit
P140-1000KT	Plunger Kit (All items in P120-1000KT plus (2) plunger pistons)

GENERAL PUMP & EQUIPMENT CO., INC.

MANUFACTURING QUALITY HYDROSTATIC TESTING EQUIPMENT FOR CONTRACTORS AND INDUSTRY SINCE 1969
3276 BRUENING AVENUE SW
CANTON, OHIO 44706
PHONE 330-455-2100
TOLL FREE 800-594-5178
EMAIL gentest@bright.net

MODEL 6334-750 & 6334-1000 HYDRO-TEST PARTS LIST

<u>PART NO.</u>	<u>DESCRIPTION</u>
PUMP HEAD	
P202-1000	Seal Retainer
P203-1000	Guide Retainer
P204-1000	Connecting Rod
P206-1000	Torque Arm *No longer available as part
P207-1000	Cylinder Head
P208-1000	O-Ring, Cylinder Head
P209-1000	Check Valve
P210-1000	Plunger (Stainless)
P211-1000	Pump Body (Old # P113A)

REPAIR TOOLS ** ALL TOOLS ARE SPECIAL ORDER

Tool A	Valve Cage Extractor
Tool B	Brush & Holder
Tool C	Sleeve Removal Rod
Tool D	Valve Seat Extractor
Tool E	Pry Bar
Tool Set	Includes All Tools A-E

INLET PIPING ** INLET MADE WITH ALL STAINLESS AND BRASS FITTINGS

I2201	1/2 x 2 SS Nipple
I2202	90 Deg SS Ell
I2203	1/2 SS Tee
I2204	1/2 x 4 1/2 SS Nipple
I2206	Garden Hose Swivel Ftg. (Brass)
I2207	Relief Hose w/ Fittings
I2208	Cone Strainer
I2209	1/2" Y-Strainer w/ 1/2 X CL HP SS Nipple
I2220	Inlet Sub-Assembly, Complete. <u>Does not include I2209 1/2"</u> Y-Strainer.
I2222	Inlet Sub-Assembly, Complete with I2209 1/2" Y-Strainer.

GENERAL PUMP & EQUIPMENT CO., INC.

MANUFACTURING QUALITY HYDROSTATIC TESTING EQUIPMENT FOR CONTRACTORS AND INDUSTRY SINCE 1969
3276 BRUENING AVENUE SW
CANTON, OHIO 44706
PHONE 330-455-2100
TOLL FREE 800-594-5178
EMAIL gentest@bright.net

MODEL 6334-750 & 6334-1000 HYDRO-TEST PARTS LIST

<u>PART NO.</u>	<u>DESCRIPTION</u>
-----------------	--------------------

OUTLET PIPING

O2101-1000	¼ X CL XH SS Nipple
O2102-750	Brass Adpt ½ x ½ (6334-750 Relief Valve)
O2102-1000	Brass Adpt ½ x 3/8 (6334-1000 Relief Valve)
O2103-750	Bronze Relief Valve (6334-750)
O2103-1000	Bronze Relief Valve (6334-1000)
O2104-750	High Pressure Ell (6334-750)
O2104-1000	High Pressure Ell (6334-1000)
O2105-1000	¼ x 2 SS Nip
O2106-1000	¼ X 1 ½ SS Nip
O2107-1000	High Pressure Tee
O2109-1000	High Pressure Needle Valve
O2110-1000	High Pressure Check Valve
O2112-1000	Glycerin Filled Gage 0-1000 psi.
O2113-1000	Brass Adapter ½ x ¼
O2114-1000	10' Outlet Hose w/ Ends
O2114-1000-20	20' Outlet Hose w/Ends
O2114-1000-30	30' Outlet Hose w/Ends
O2115-1000	Brass Adapter ½ x ½ (For hose)
O2120-750	Outlet Sub-Assy Complete (Does not include outlet hose.)
O2120-1000	Outlet Sub-Assy Complete (Does not include outlet hose.)
O2118	Outlet Support Bracket

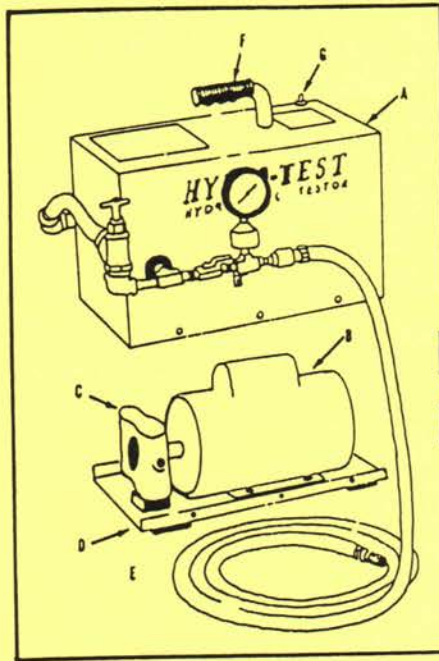

MODEL 6334-750 and 6334-1000 HYDRO-TEST PARTS LIST

TO ORDER PARTS: Give part number and part description. ALSO give COMPLETE pump model number - include all letters which appear before and after model number. Reference numbers are used ONLY to identify parts in drawing; do not use for ordering.

MAJOR PARTS

Ref. Number	Qty. Used	Description	Part Number
B	1	TEFC Motor 1 H.P. (6334-750)	B12-750
B	1	TEFC Motor 1½ H.P. (6334-1000)	B12-1000
C	1	HT2-1000 Pump (6334-750 & 1000)	B14-1000
C	1	HT2-1000R Rebuilt Pump (Exchange)	B15-1000
E	4	Rubber Vibration Isolators	B16
G	1	Toggle Switch (6334-750)	B19
G	1	Toggle Switch (6334-1000)	B19-1000

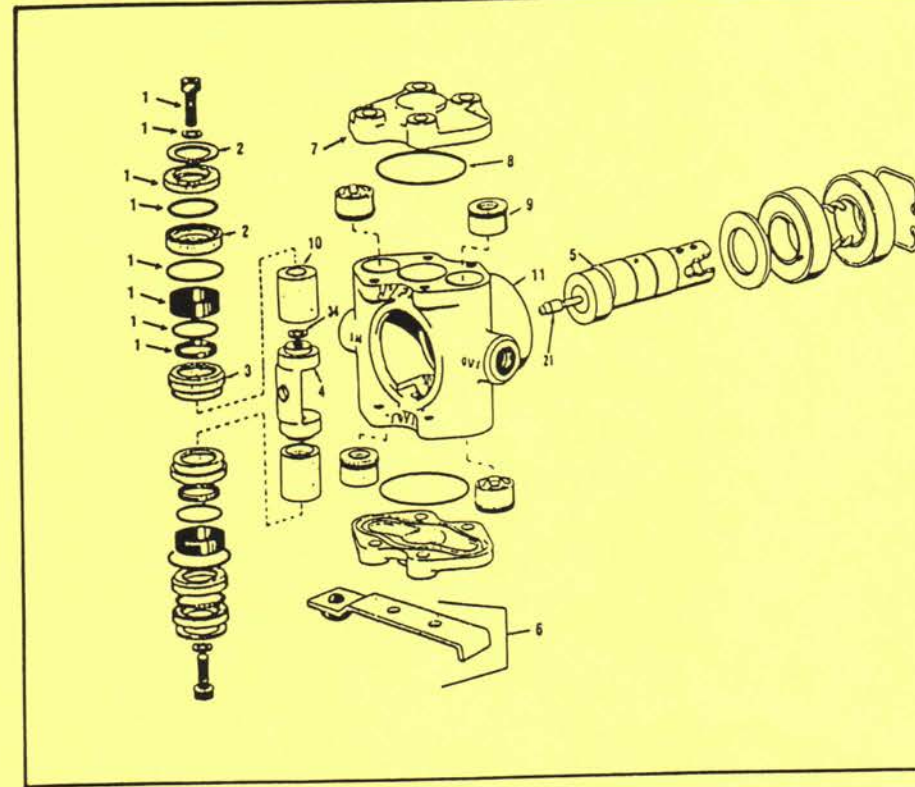

PUMP HEAD

Use for 6334-750 and 6334-1000
A.R1.5-1000 GHT31000

Ref. Number	Qty. Used	Description	Part Number
1	1	Piston Repair Kit	P201-1000
2	2	Seal Retainer	P202-1000
3	2	Guide Retainer	P203-1000
4	1	Connecting Rod	P204-1000
5	1	Crankshaft	P205-1000
6	1	Torque Arm	P206-1000
7	2	Cylinder Head	P207-1000
8	2	O-Ring (Cylinder Head)	P208-1000
9	4	Check Valves	P209-1000
10	2	Plunger (Stainless)	P210-1000
11	1	Pump Body	P211-1000

For complete repair kits see parts price sheet

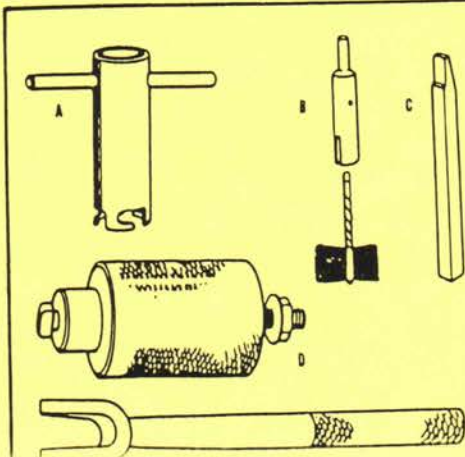

REPAIR TOOLS for HYDRO-TEST 6334 PISTON PUMPS

A-Valve Cage Extractor
B-Brush & Holder
C-Sleeve Removal Rod
D-Valve Seat Extractor
E-Pry Bar
Complete Set



INLET PIPING

Ref. Number	Qty. Used	Description	Part Number
14	1	Nipple	12201
15	1	90° Ell	12202
16	1	Tee	12203
17	1	Nipple	12204
19	1	Hose Swivel Fitting	12206
20	1	Relief Hose with Fittings	12207

OUTLET PIPING

Ref. Number	Qty. Used	Description	Part Number
2	1	Brass Adapter (6334-750)	02102-750
2	1	Brass Adapter (6334-1000)	02102-1000
3	1	Bronze Relief Valve (6334-750)	02103-750
3	1	Bronze Relief Valve (6334-1000)	02103-1000
4	1	High Pressure Ell (6334-750)	02104-750
4	1	High Pressure Ell (6334-1000)	02104-1000
5	5	Stainless Steel Nipple	02105-1000

Ref. Number	Qty. Used	Description	Part Number
7	2	High Pressure Tee	02107-1000
9	1	High Pressure Needle Valve	02109-1000
10	1	High Pressure Check Valve	02110-1000
11	1	Glycerine Filled Gage (0-1000)	02112-1000
12	1	Brass Adapter	02113-1000
13	1	10' High Pressure Hose	02114-1000
14	1	Brass Adapter	02115-1000

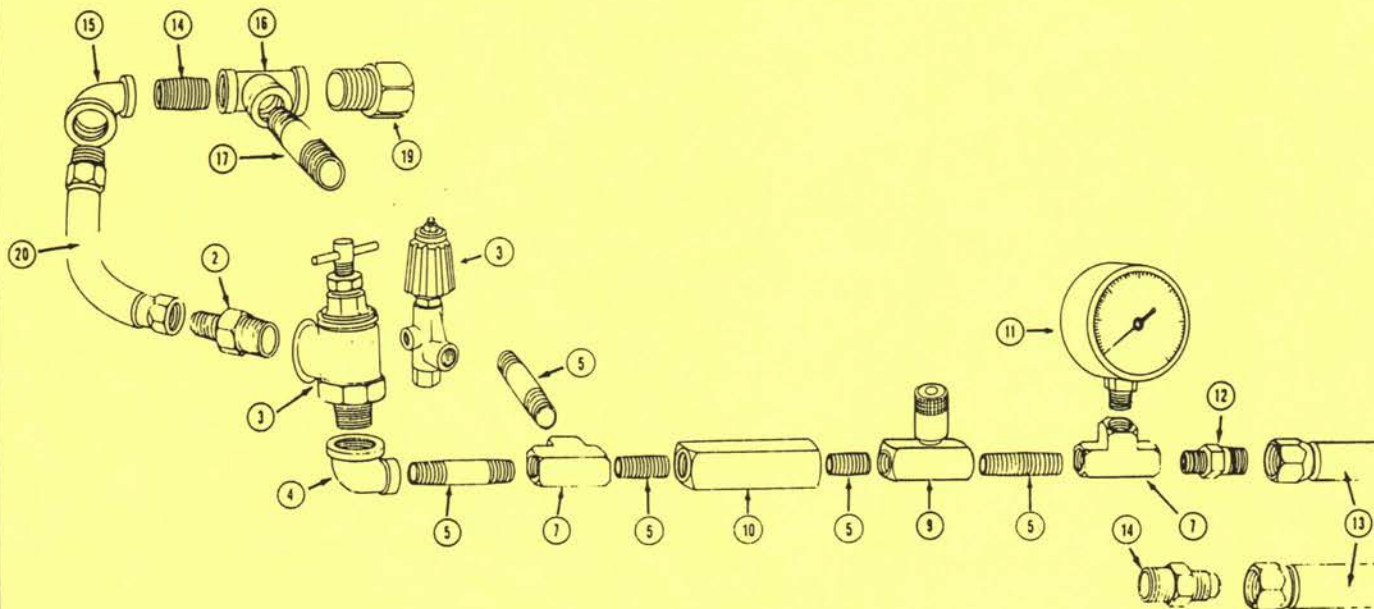

GENERAL
PUMP
& EQUIPMENT CO.

3276 Bruening Circle, S.W. • P. O. Box 6380 - Sta. B

CANTON, OHIO 44706

PHONE: A.C. 330/455-2100

FAX: A.C. 330/455-4904

ORDER DESK: 1-800-594-5178